

# Midea EVOX R-454B 24V Quick Start Guide

## Midea wiring connection guide

\*Note: Power Unit off before changing dip switch settings

Scenario	Controller	Indoor unit	Outdoor unit	Connection between Indoor and outdoor	Air Handling Unit Dip Switch Settings		Outdoor Unit Switch Settings
					SW1-1	SW1-4	S1-2
<a href="#">Scenario 1 (Recommend)</a>	Midea controller (Standard/M-station)	Midea AHU	Midea ODU	RS485: S1/S2	OFF (Default)	OFF (Default)	OFF (Default)
<a href="#">Scenario 2</a>	24V Thermostat	Midea AHU	Midea ODU	RS485: S1/S2	ON	OFF (Default)	OFF (Default)
<a href="#">Scenario 3</a>	24V Thermostat	Midea AHU	Midea ODU	24V: R/C/B/Y1/Y2/G/W	ON	ON	ON

### Scenario 1: Factory Control System

Midea controller (Standard/M-Station)



Order Separately

HA/HB +

Midea Gen 2 / G<sup>3</sup> Air Handler

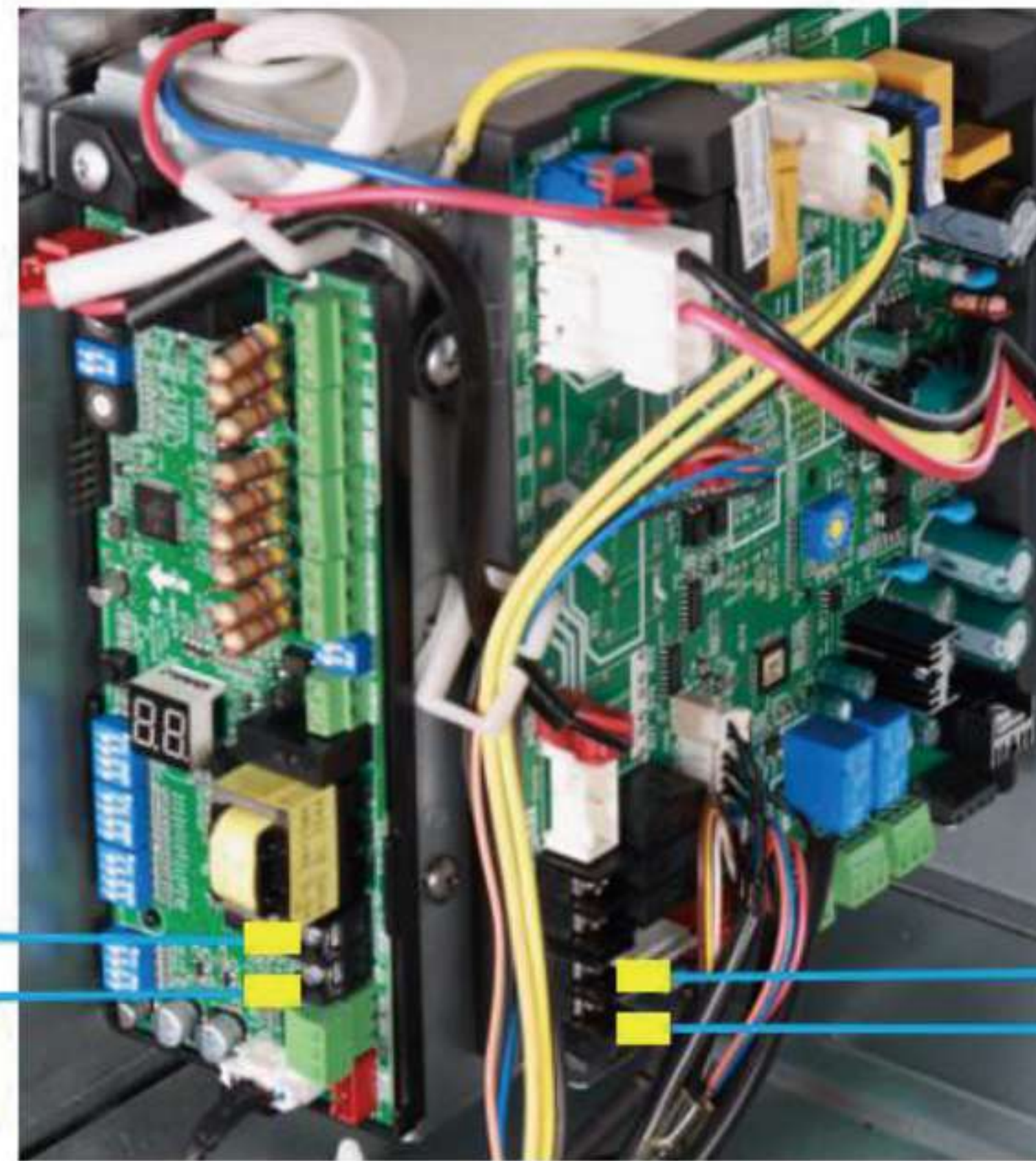

S1/S2 +

Midea Outdoor unit



HA/HB

S1 / S2  
14-2 Multi-Strand Shielded

**NAHVAC**  
North American HVAC

**North American HVAC Products Ltd.**

Add.: #100 5118 N Fraser Wy, Burnaby, BC V5J 0H1

Tel: 604-430-8496 info@nahvac.com www.nahvac.com

# Midea EVOX R-454B 24V Quick Start Guide

Scenario 2:

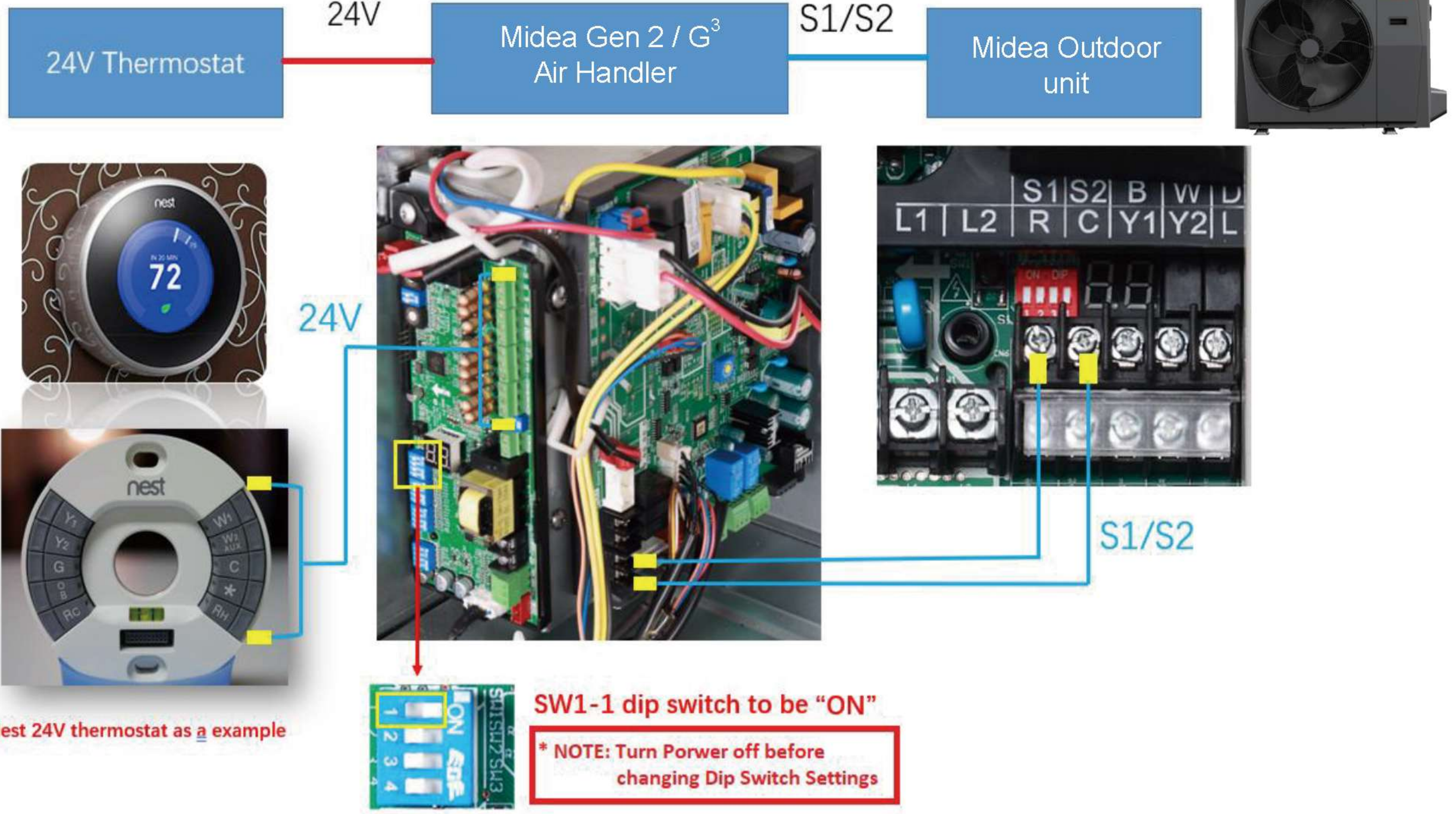

Scenario 3:

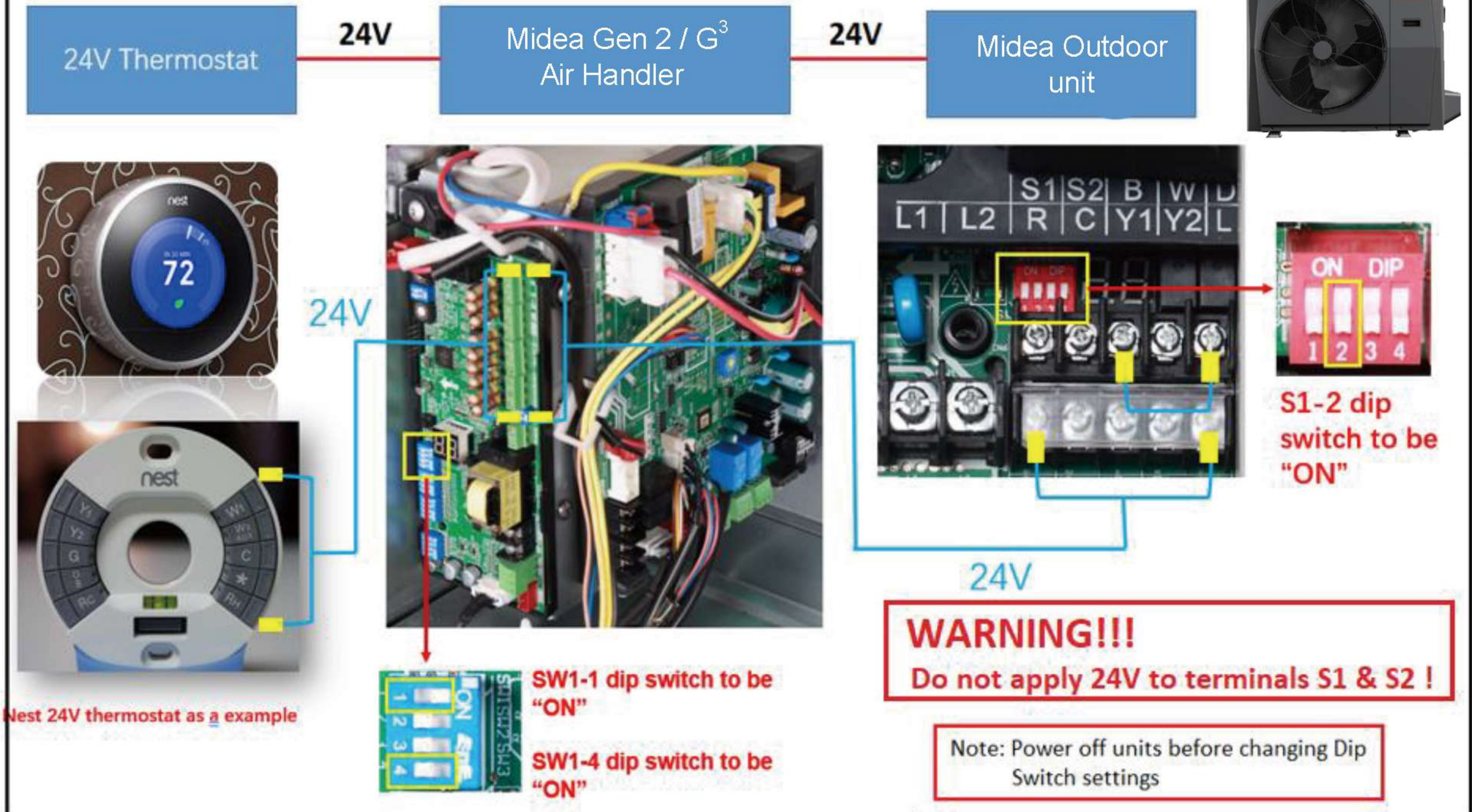

**North American HVAC Products Ltd.**

Add.: #100 5118 N Fraser Wy, Burnaby, BC V5J 0H1

Tel: 604-430-8496 info@nahvac.com www.nahvac.com